

# WASHBASIN

PLA

Material : Corian.  
Colour : Glacier White

## MOD. PLA / 13

\*\* IN ORDER TO ALLOW US TO LEAVE THE CORRECT HOLE FOR THE FAUCET IN THE WASHBASIN WALL, THE TECHNICAL SPECIFICATION OF THE FAUCET WOULD BE REQUIRED \*\*.

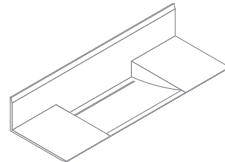
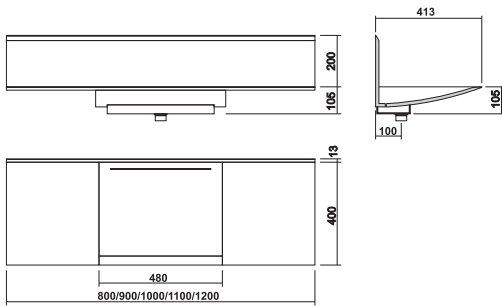

### STANDARD SIZES (mm.)

Standard Size (mm.)	Equivalent Size (inches)	Ref. Code
800 x 410 x 13	(31,49"x16,14"x0,51")	PLAB2121
900 x 410 x 13	(35,43"x16,14"x0,51")	PLAB2122
1000 x 410 x 13	(39,37"x16,14"x0,51")	PLAB2123
1100 x 410 x 13	(43,30"x16,14"x0,51")	PLAB2124
1200 x 410 x 13	(47,24"x16,14"x0,51")	PLAB2125

OPTIONS :  
2 Holding Squares.  
Siphon CR.

SOP1  
SIF1

\*\* HOME MADE MANUFACTURING. ANY OTHER MEASURES, MATERIALS AND COLOURS TO BE CONSULTED \*\*.

## MOD. PLA / 45

\*\* IN ORDER TO ALLOW US TO LEAVE THE CORRECT HOLE FOR THE FAUCET IN THE WASHBASIN WALL, THE TECHNICAL SPECIFICATION OF THE FAUCET WOULD BE REQUIRED \*\*.

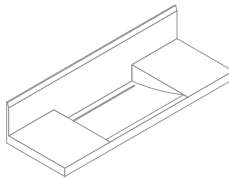
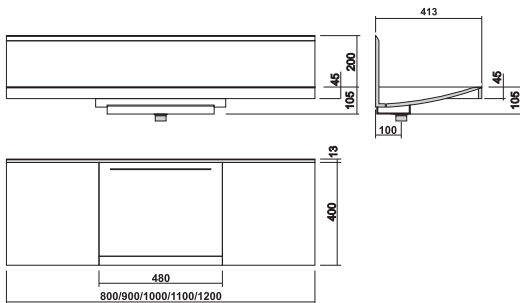

### STANDARD SIZES (mm.)

Standard Size (mm.)	Equivalent Size (inches)	Ref. Code
800 x 410 x 45	(31,49"x16,14"x1,77")	PLAB2121
900 x 410 x 45	(35,43"x16,14"x1,77")	PLAB2122
1000 x 410 x 45	(39,37"x16,14"x1,77")	PLAB2123
1100 x 410 x 45	(43,30"x16,14"x1,77")	PLAB2124
1200 x 410 x 45	(47,24"x16,14"x1,77")	PLAB2125

OPTIONS :  
2 Holding Squares.  
Siphon CR.

SOP1  
SIF1

\*\* HOME MADE MANUFACTURING. ANY OTHER MEASURES, MATERIALS AND COLOURS TO BE CONSULTED \*\*.

## MOD. PLA / 80

\*\* IN ORDER TO ALLOW US TO LEAVE THE CORRECT HOLE FOR THE FAUCET IN THE WASHBASIN WALL, THE TECHNICAL SPECIFICATION OF THE FAUCET WOULD BE REQUIRED \*\*.

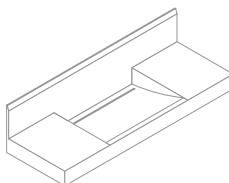
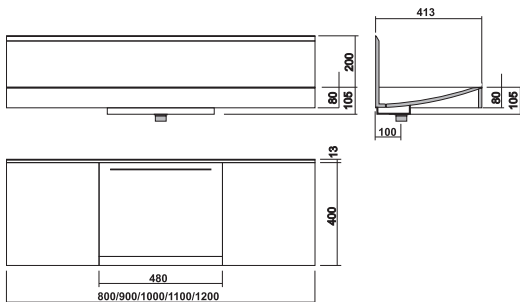

### STANDARD SIZES (mm.)

Standard Size (mm.)	Equivalent Size (inches)	Ref. Code
800 x 410 x 80	(31,49"x16,14"x3,14")	PLAB2121
900 x 410 x 80	(35,43"x16,14"x3,14")	PLAB2122
1000 x 410 x 80	(39,37"x16,14"x3,14")	PLAB2123
1100 x 410 x 80	(43,30"x16,14"x3,14")	PLAB2124
1200 x 410 x 80	(47,24"x16,14"x3,14")	PLAB2125

OPTIONS :  
2 Holding Squares.  
Siphon CR.

SOP1  
SIF1

\*\* HOME MADE MANUFACTURING. ANY OTHER MEASURES, MATERIALS AND COLOURS TO BE CONSULTED \*\*.