

WASHBASIN

Material : Corian.
 Colour : Glacier White.

MOD. PLA 2 /13

** IN ORDER TO ALLOW US TO LEAVE THE CORRECT HOLE FOR THE FAUCET IN THE WASHBASIN WALL, THE TECHNICAL SPECIFICATION OF THE FAUCET WOULD BE REQUIRED **.

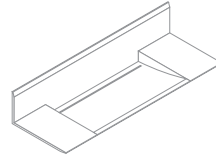
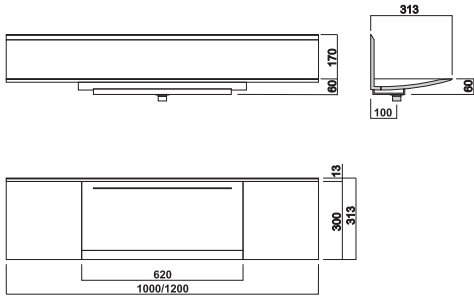

STANDARD SIZES (mm.)

1000 x 313 x 13	(39,37"x12,32"x0,51")
1100 x 313 x 13	(43,30"x12,32"x0,51")
1200 x 313 x 13	(47,24"x12,32"x0,51")

Ref. Code

PLAC2113
PLAC2114
PLAC2115

OPTIONS :

2 Holding Squares
 Siphon CR

SOP1
 SIF1

** HOME MADE MANUFACTURING. ANY OTHER MEASURES, MATERIALS AND COLOURS TO BE CONSULTED **.

MOD. PLA 2 /45

** IN ORDER TO ALLOW US TO LEAVE THE CORRECT HOLE FOR THE FAUCET IN THE WASHBASIN WALL, THE TECHNICAL SPECIFICATION OF THE FAUCET WOULD BE REQUIRED **.

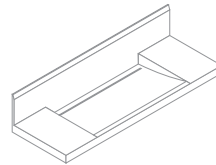
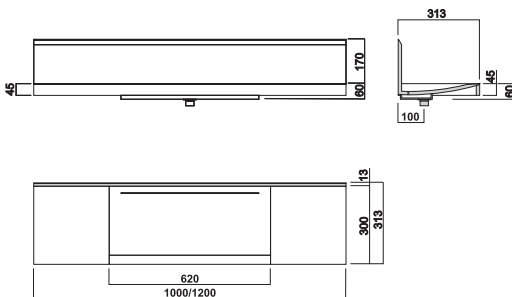

STANDARD SIZES (mm.)

1000 x 313 x 45	(39,37"x12,32"x1,77")
1100 x 313 x 45	(43,30"x12,32"x1,77")
1200 x 313 x 45	(47,24"x12,32"x1,77")

Ref. Code

PLAC2113
PLAC2114
PLAC2115

OPTIONS :

2 Holding Squares
 Siphon CR

SOP1
 SIF1

** HOME MADE MANUFACTURING. ANY OTHER MEASURES, MATERIALS AND COLOURS TO BE CONSULTED **.

MOD. PLA 2 /80

** IN ORDER TO ALLOW US TO LEAVE THE CORRECT HOLE FOR THE FAUCET IN THE WASHBASIN WALL, THE TECHNICAL SPECIFICATION OF THE FAUCET WOULD BE REQUIRED **.

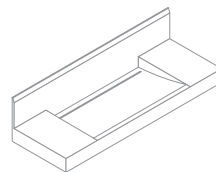
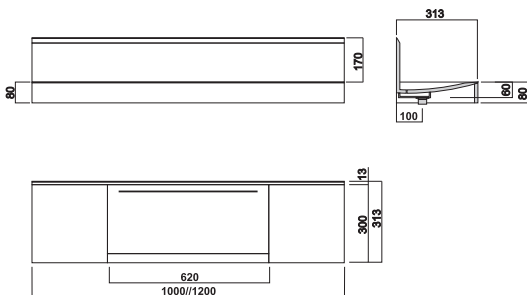

STANDARD SIZES (mm.)

1000 x 313 x 80	(39,37"x12,32"x3,14")
1100 x 313 x 80	(43,30"x12,32"x3,14")
1200 x 313 x 80	(47,24"x12,32"x3,14")

Ref. Code

PLAC2113
PLAC2114
PLAC2115

OPTIONS :

2 Holding Squares
 Siphon CR

SOP1
 SIF1

** HOME MADE MANUFACTURING. ANY OTHER MEASURES, MATERIALS AND COLOURS TO BE CONSULTED **.