

# MUEBLES COMBINABLES

**RCR**

LAVAMANOS COMPATIBLES

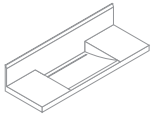

**PLA / (13)-(45)-(80)**  
800 x 413 x (13)-(45)-(80)  
900 x 413 x (13)-(45)-(80)

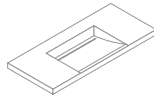

**PLA 1 / (13)-(45)-(80)**  
800 x 510 x (13)-(45)-(80)  
900 x 510 x (13)-(45)-(80)

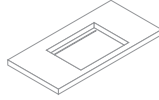

**PLA 210 / (13)-(45)-(80)**  
800 x 510 x (13)-(45)-(80)  
900 x 510 x (13)-(45)-(80)

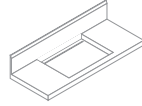

**PLA 211 / (13)-(45)-(80)**  
800 x 413 x (13)-(45)-(80)  
900 x 413 x (13)-(45)-(80)

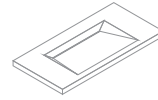

**PLA 310 / (13)-(45)-(80)**  
900 x 510 x (13)-(45)-(80)

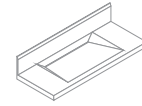

**PLA 311 / (13)-(45)-(80)**  
900 x 413 x (13)-(45)-(80)

## RCR 800 / A

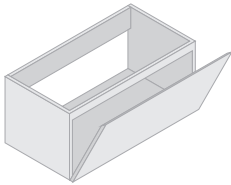

Módulo compuesto de Puerta Abatible.

| MEDIDAS ESTÁNDAR : | Refª.Art. |
|--------------------|-----------|
| 800 x 413 x 365    | R800A27   |
| 800 x 510 x 365    | R800A57   |

| ACABADOS :            | Refª.                   |
|-----------------------|-------------------------|
| Corian blanco GW.     | C1                      |
| Lacado blanco mate.   | L3                      |
| Lacado colores mate : | Verde / Granate L1 / L2 |
| Chapas madera :       | Roble Natural M1        |
|                       | Roble Wengue M2         |
|                       | Roble Decapado M3       |

\*\* FABRICACIÓN PROPIA.OTRAS MEDIDAS, MATERIALES Y COLORES A CONSULTAR \*\*.

## RCR 800 / 1C

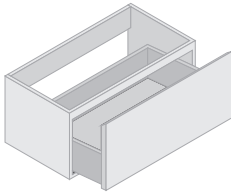

Módulo compuesto de 1 Cajón.

| MEDIDAS ESTÁNDAR : | Refª.Art. |
|--------------------|-----------|
| 800 x 413 x 365    | R800B27   |
| 800 x 510 x 365    | R800B57   |

| ACABADOS :            | Refª.                   |
|-----------------------|-------------------------|
| Corian blanco GW.     | C1                      |
| Lacado blanco mate.   | L3                      |
| Lacado colores mate : | Verde / Granate L1 / L2 |
| Chapas madera :       | Roble Natural M1        |
|                       | Roble Wengue M2         |
|                       | Roble Decapado M3       |

\*\* FABRICACIÓN PROPIA.OTRAS MEDIDAS, MATERIALES Y COLORES A CONSULTAR \*\*.

## RCR 800 / 2C

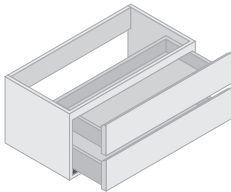

Módulo compuesto de 2 Cajones.

| MEDIDAS ESTÁNDAR : | Refª.Art. |
|--------------------|-----------|
| 800 x 413 x 365    | R800C27   |
| 800 x 510 x 365    | R800C57   |

| ACABADOS :            | Refª.                   |
|-----------------------|-------------------------|
| Corian blanco GW.     | C1                      |
| Lacado blanco mate.   | L3                      |
| Lacado colores mate : | Verde / Granate L1 / L2 |
| Chapas madera :       | Roble Natural M1        |
|                       | Roble Wengue M2         |
|                       | Roble Decapado M3       |

\*\* FABRICACIÓN PROPIA.OTRAS MEDIDAS, MATERIALES Y COLORES A CONSULTAR \*\*.

## RCR 900 / A

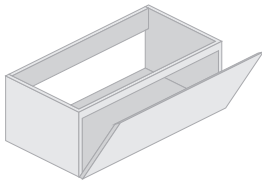

Módulo compuesto de Puerta Abatible.

| MEDIDAS ESTÁNDAR : | Refª.Art. |
|--------------------|-----------|
| 900 x 413 x 365    | R900A28   |
| 900 x 510 x 365    | R900A58   |

| ACABADOS :            | Refª.                   |
|-----------------------|-------------------------|
| Corian blanco GW.     | C1                      |
| Lacado blanco mate.   | L3                      |
| Lacado colores mate : | Verde / Granate L1 / L2 |
| Chapas madera :       | Roble Natural M1        |
|                       | Roble Wengue M2         |
|                       | Roble Decapado M3       |

\*\* FABRICACIÓN PROPIA.OTRAS MEDIDAS, MATERIALES Y COLORES A CONSULTAR \*\*.

## RCR 900 / 1C

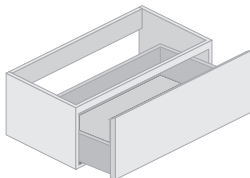

Módulo compuesto de 1 Cajón.

| MEDIDAS ESTÁNDAR : | Refª.Art. |
|--------------------|-----------|
| 900 x 413 x 365    | R900B28   |
| 900 x 510 x 365    | R900B58   |

| ACABADOS :            | Refª.                   |
|-----------------------|-------------------------|
| Corian blanco GW.     | C1                      |
| Lacado blanco mate.   | L3                      |
| Lacado colores mate : | Verde / Granate L1 / L2 |
| Chapas madera :       | Roble Natural M1        |
|                       | Roble Wengue M2         |
|                       | Roble Decapado M3       |

\*\* FABRICACIÓN PROPIA.OTRAS MEDIDAS, MATERIALES Y COLORES A CONSULTAR \*\*.

## RCR 900 / 2C

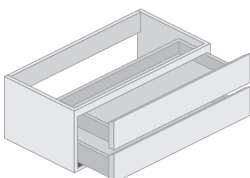

Módulo compuesto de 2 Cajones.

| MEDIDAS ESTÁNDAR : | Refª.Art. |
|--------------------|-----------|
| 900 x 413 x 365    | R900C27   |
| 900 x 510 x 365    | R900C57   |

| ACABADOS :            | Refª.                   |
|-----------------------|-------------------------|
| Corian blanco GW.     | C1                      |
| Lacado blanco mate.   | L3                      |
| Lacado colores mate : | Verde / Granate L1 / L2 |
| Chapas madera :       | Roble Natural M1        |
|                       | Roble Wengue M2         |
|                       | Roble Decapado M3       |

\*\* FABRICACIÓN PROPIA.OTRAS MEDIDAS, MATERIALES Y COLORES A CONSULTAR \*\*.